

INSTALLATION INSTRUCTIONS FOR SENSOR UR PLATE

SLOAN®

Model & Description:-

SGV-7905 - Sensor UR 0.5 LPF Plate - CP

SGV-7910 - Sensor UR 1.0 LPF Plate - CP

SGV-7915 - Sensor UR 1.5 LPF Plate - CP



INSIDE THE BOX & IMPORTANT

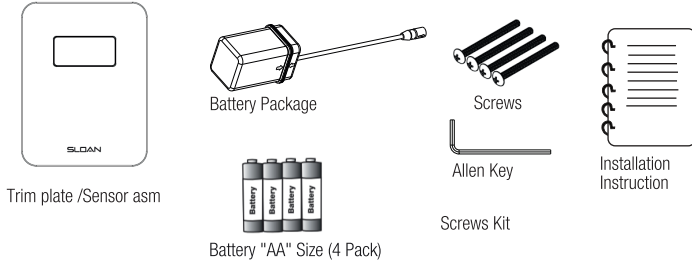

Important:

- ALL ELECTRICAL WIRING IS TO BE INSTALLED IN ACCORDANCE WITH NATIONAL/LOCAL CODES AND REGULATIONS.
- ALL PLUMBING IS TO BE INSTALLED IN ACCORDANCE WITH APPLICABLE CODES AND REGULATIONS.
- SLOAN URINAL VALVE IS DESIGNED TO OPERATE WITH 0.7 TO 5.5 BAR OF WATER PRESSURE.
- WATER SUPPLY LINES MUST BE SIZED TO PROVIDE AN ADEQUATE VOLUME OF WATER FOR EACH FIXTURE.
- FLUSH ALL WATER LINES PRIOR TO MAKING CONNECTIONS.
- KEEP THREAD SEALANT OUT OF YOUR WATERWAY TO PREVENT COMPONENT PARTT DAMAGE! DO NOT APP Y SEALANT TO THE FIRST TWO "STARTER" THREADS.
- WHEN OPTIONAL TRANSFORMER IS USED — A 6 VAC STEP-DOWN TRANSFORMER MUST BE USED.

- USE APPROPRIATE PRECAUTIONS WHILE CONNECTING TRANSFORMER TO 220 VAC POWER

SOURCE-Sloan ELG-220(220VAC/ 6VAC(Transformer not provided)

RECOMMENDED TOOLS



PRIOR TO INSTALLATION

Prior to installing the Sloan Flush Valve, install the items listed below

- Ensure SVG7900 Sensor UR Universal Valve is installed with proper line connection.
- Level the surface.

INSTALLATION STEP:-

1 Remove the Mud gaurd

- Open 4 screw by Screw driver & Remove the Mud gaurd

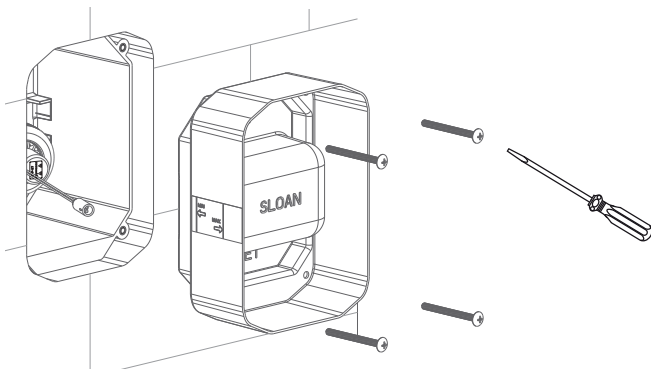

2 Install the Mounting plate with spacer on the Concealed Box

- Install the Mounting plate with spacer on the Concealed Box & tightned 4 screw by screw driver

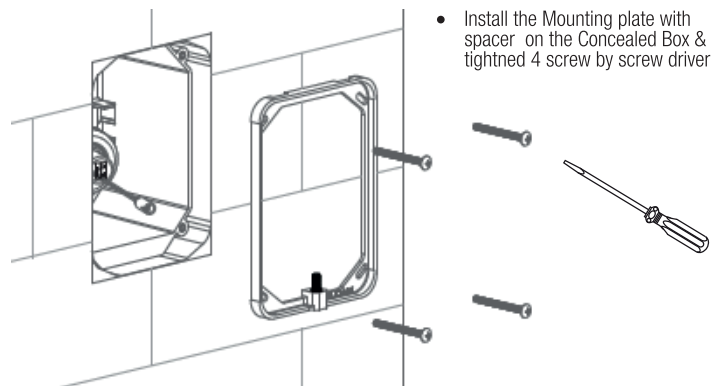

3 Install Battery Compartment and Run Electrical Line into Wall Box (Hardwire Installations Only)

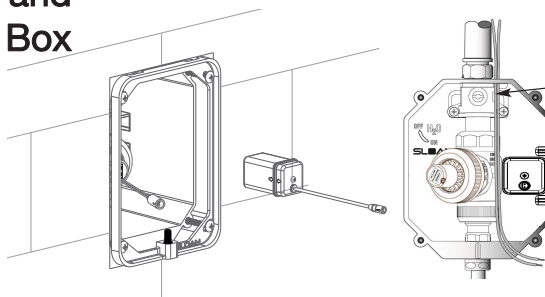

ELECTRICAL LINE FROM TRANSFORMER (OPTIONAL)
Sloan
ELG-220(220VAC/ 6VAC(Transformer not provided)

- Ⓑ When installing the optional Transformer,run electrical line from Transformer through opening in top of plumbing Assemble Wall box

4 Connect Electrical Components

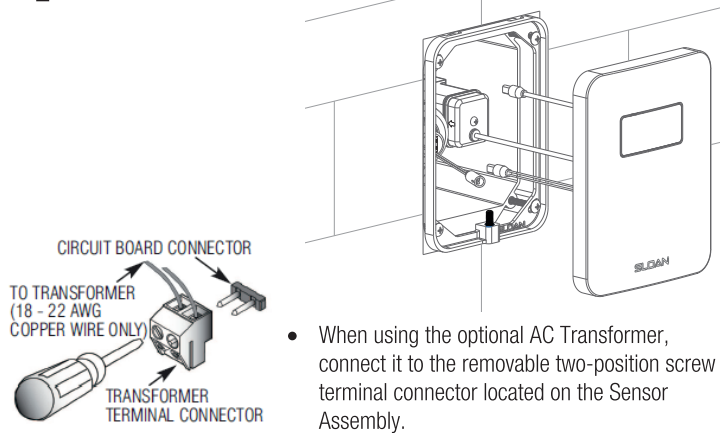

5 Mount The Trim Plate Assembly on Wall Insert

- Turn on the Ball Valve
- Mount the trim plate assembly on the wall insert as shown.

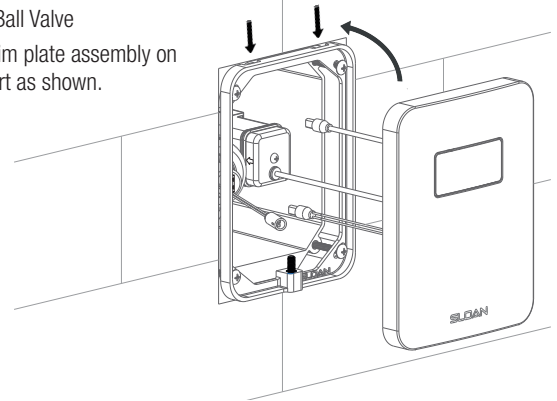

6 Fix the Wall plate

- Mount the Trim plate /Sensor asm & Unscrew the retaining screw using supplied Allen key until it touches Trim plate

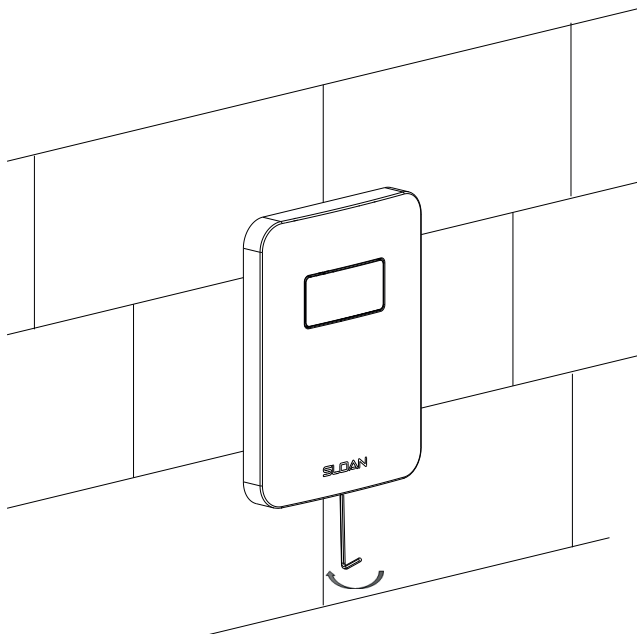

7 Finish the wall

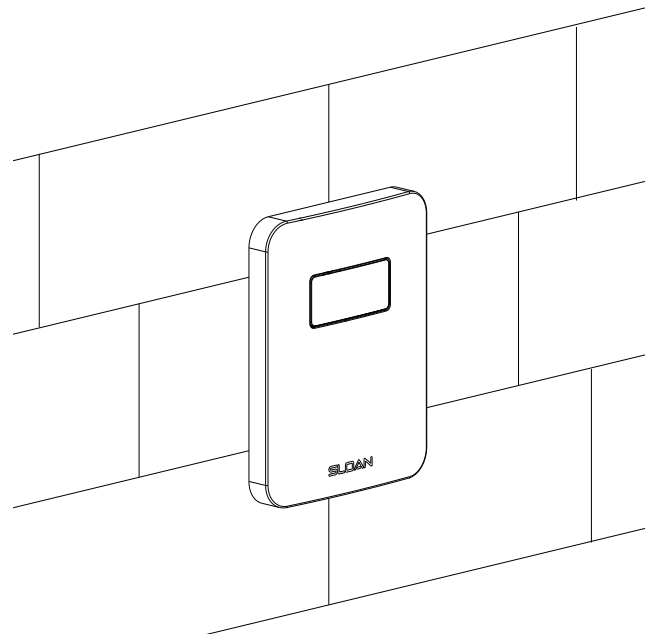

LIMITED WARRANTY

Unless otherwise noted, Sloan India Pvt. Ltd warrants this product, manufactured and sold for commercial or industrial uses, to be free from defects in material and workmanship for a period of Five (5) years and 1 Year- All Electronic & battery not covered in warranty from date of first purchase. During this period, Sloan India Pvt. Ltd will, at its option, repair, replace, or refund the purchase price of any product which fails to conform with this warranty under normal use and service. This shall be the sole and exclusive remedy under this warranty. Products must be returned to Sloan India Pvt. Ltd, at customer's cost. No claims will be allowed for labor, transportation or other costs. This warranty extends only to persons or organizations who purchase Sloan's products directly from Sloan India Pvt. Ltd for purpose of resale. This warranty does not cover the life of the batteries.

THERE ARE NO WARRANTIES WHICH EXTEND BEYOND THE DESCRIPTION ON THE FACE HEREOF. IN NO EVENT IS SLOAN VALVE COMPANY RESPONSIBLE FOR ANY CONSEQUENTIAL DAMAGES OF ANY MEASURE WHATSOEVER.

SLOAN.
SLOAN INDIA PRIVATE LIMITED

344, PHASE-II UDYOG VIHAR, GURGAON 122015 Phone: (+91) 124-4908588/87
Toll Free: 1800.123.3080 | customercare@sloan.in | sloan.in | copyright © 2021 Sloan All rights reserved