

INSTALLATION INSTRUCTIONS FOR TRUFLUSH MANUAL CLOSET AND URINAL FLUSHOMETERS

TruFlush Models:



3401010
3401006
3401007
3401008
34000005
34000046
34000048

SLOAN® INDIA PRIVATE LIMITED — LIMITED WARRANTY SUMMARY

Sloan India Private Limited ("Sloan"), warrants its products against defects in materials and workmanship, excluding damage caused by matters beyond Sloan's reasonable control. Instructions for filing claims can be found in the Limited Warranty which can be obtained at <https://www.sloan.com/company/international/sloanindia> or by requesting a free copy by telephone to Sloan India toll free number 1 800 123 3080 or via Landline: +91 124 490 8588. Sloan will repair or replace your defective product, or provide a refund, as your exclusive remedy.

This is only a general summary of Sloan's Limited Warranty so it is important to note that the specific terms, conditions, limitations and exclusions, including the duration of warranty coverage for your particular Sloan product, are contained in the actual Sloan Limited Warranty. The Limited Warranty is subject to applicable laws in your country, state, province or other jurisdiction—and disputes arising under the Limited Warranty are to be resolved by binding arbitration unless you provide Sloan with an opt-out notice no later than 30 days after your purchase date. In case of a conflict with this summary, the terms and conditions set forth in the complete Limited Warranty will prevail.

PRIOR TO INSTALLATION

This valve is designed for new construction or where there is easily accessed plumbing for the fixture and the valve. This valve is designed for minimum six inch (153 mm) wall space depth. Distance from center of the valve (inlet or outlet pipe) to the finished surface of the wall can vary from 2"-3" (51-76 mm).

Wall plate opening must be minimum of 4" x 4" (102 x 102 mm) to maximum of 4.5" x 4.5" (114 mm x 114 mm). Mud plate is provided and must accompany valve for proper installation. Mud plate is removed after wall is finished.

TOOLS REQUIRED FOR INSTALLATION

- Phillips screwdriver



- Adjusting tool (supplied)

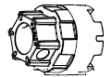

- Leveler



ITEMS INCLUDED WITH THE PRODUCT

VALVE BOX

1. Valve assembly
2. Mud Guard
3. (2) #10-32 x 2-1/2 screws to secure mud guard
4. (2) 1/4"-20 x 2" screws to remove activation assembly
5. Adjusting tool
6. Installation instructions
7. Reducing Connector**

1. Valve Assembly

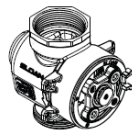

2. Mud Guard

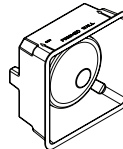

3. Mud Guard Screws



4. Activation Assembly
Screws



5. Adjusting Tool



6. Instructions



7. Reducing Connector 32x25



**Applicable for 25mm Inlet Valves Only

ROUGH-IN

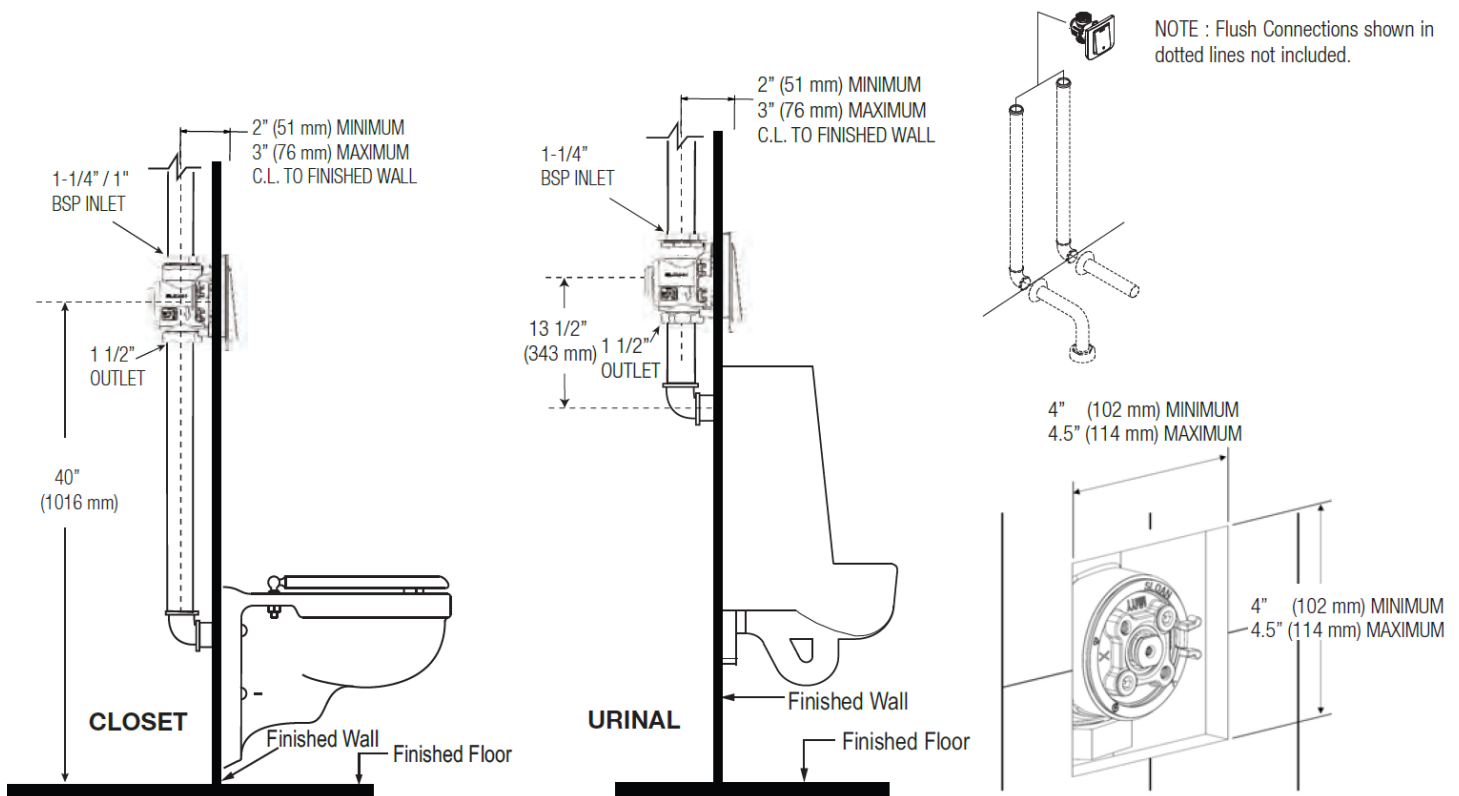

!!! IMPORTANT !!!

SLOAN'S FLUSHOMETERS ARE DESIGNED TO OPERATE WITH 20 TO 80 PSI (138 TO 552 KPA) OF WATER PRESSURE. **THE MINIMUM PRESSURE REQUIRED TO THE VALVE IS DETERMINED BY THE TYPE OF FIXTURE SELECTED.** CONSULT FIXTURE MANUFACTURER FOR MINIMUM PRESSURE REQUIREMENTS. MOST HIGH EFFICIENCY WATER CLOSETS REQUIRE A MINIMUM FLOWING PRESSURE OF 25 PSI (172 KPA). MANY BUILDING CODES AND THE ASME A112.19.2 FIXTURE STANDARD LIST MAXIMUM STATIC WATER PRESSURE AS 80 PSI (552 KPA).

!!! IMPORTANT !!!

WITH THE EXCEPTION OF INLET, DO NOT USE PIPE THREAD SEALANT. DO NOT USE PLUMBING GREASE ON VALVE COMPONENTS OR COUPLINGS!

1. CONNECT FLUSHOMETER

1. Remove the mud guard and save for later use - **DO NOT DISCARD.**

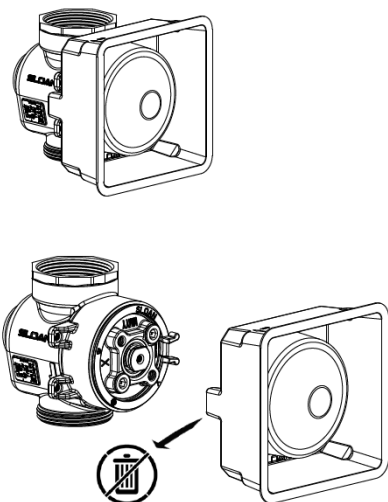

2. Apply teflon tape on reducing connector and connect to top ("IN") of flushometer. There must not be any leakage.

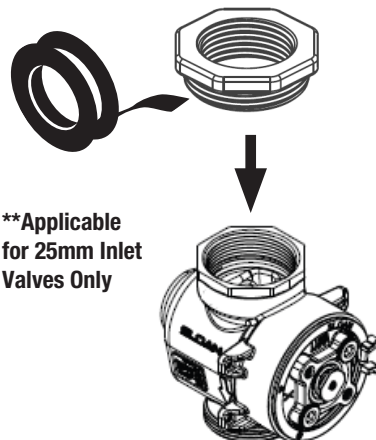

3. Connect the inlet pipe to top ("IN") and fixture flush connection to bottom ("OUT") of flushometer.

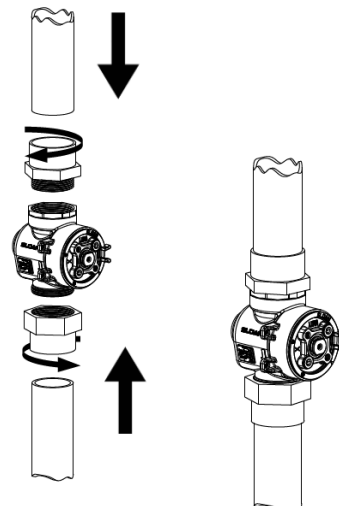

1. CONNECT FLUSHOMETER, CONTINUED

4. Reinstall mud guard to valve. Use the mud guard screws (supplied).

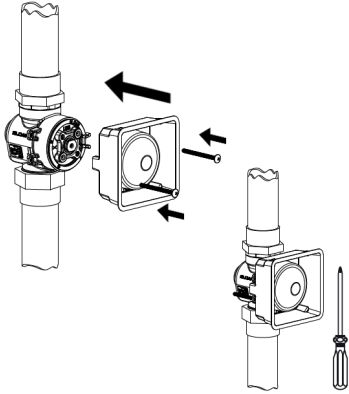

5. Finish the wall. Use marks on mudguard to make sure finished wall is in between 2" (51 mm) and 3" (76 mm) from centerline of the inlet pipe.

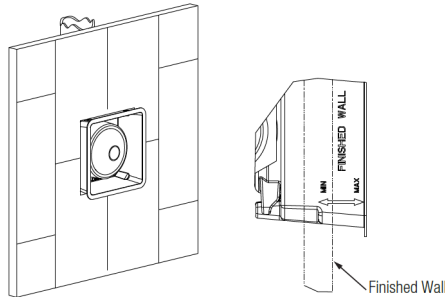

6. Remove mud guard and discard.

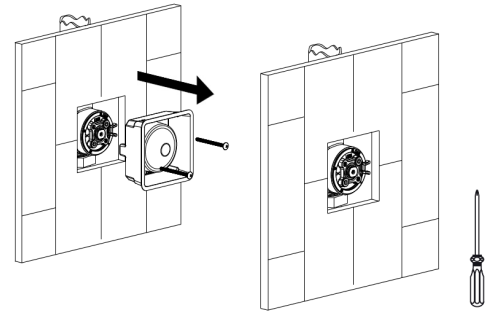

2. ADJUST CONTROL FLOW

1. Ensure the activation assembly is turned fully clockwise. If not, use the adjustment tool (supplied) to turn it to fully closed.

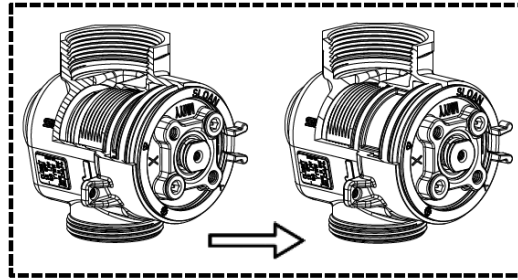
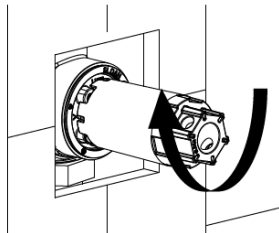

2. Push the plunger in the center to relieve pressure inside the flushometer.

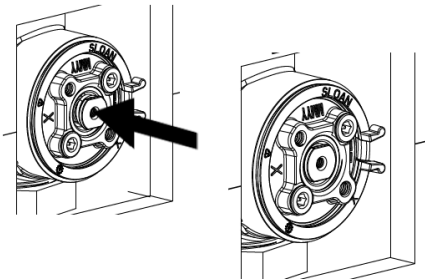

3. Push the activation assembly until fully seated.

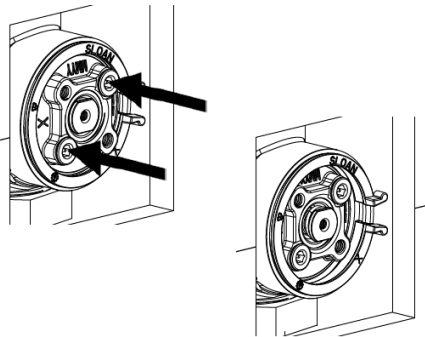

4. Squeeze and then pull the safety ring out.

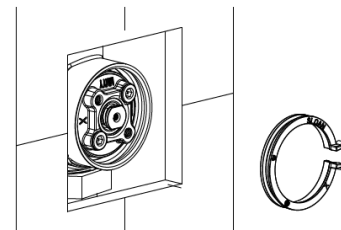
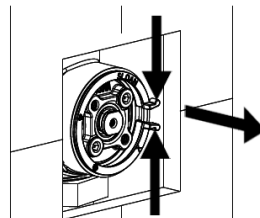

5. Use activation assembly screws (supplied) to pull the activation assembly out along with the piston and conical spring.

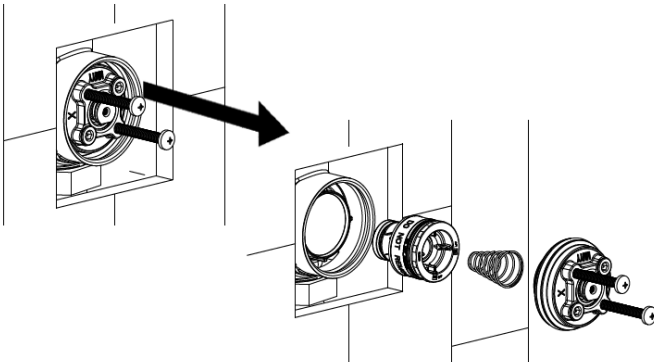

6. Keep the piston and conical spring aside - **DO NOT DISCARD** - and reinstall the activation assembly and the safety ring.

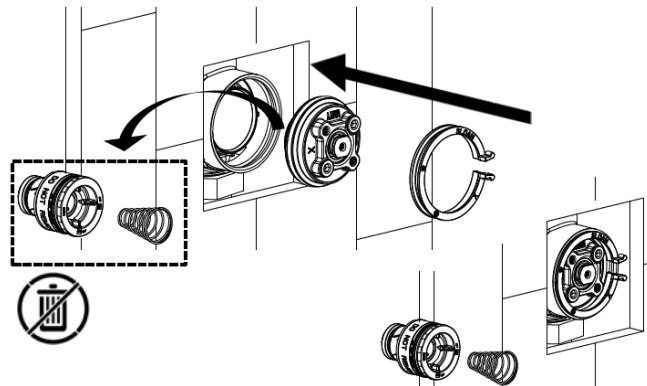

2. ADJUST CONTROL FLOW, CONTINUED

7. Using the activation tool, turn the activation assembly counterclockwise to open the water flow to flush the supply lines - careful not to overflow the fixture. After the supply lines are cleaned, turn the activation assembly clockwise to completely shut off the flow of water.

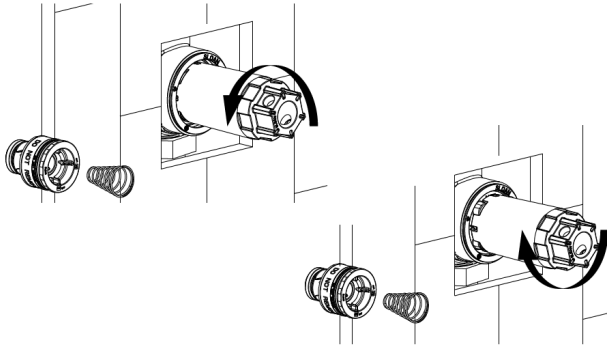

8. Remove the activation assembly using the activation assembly screws.
9. If the valve was flushed before any of the above steps were followed, then wash the piston thoroughly using clean water prior to installation.

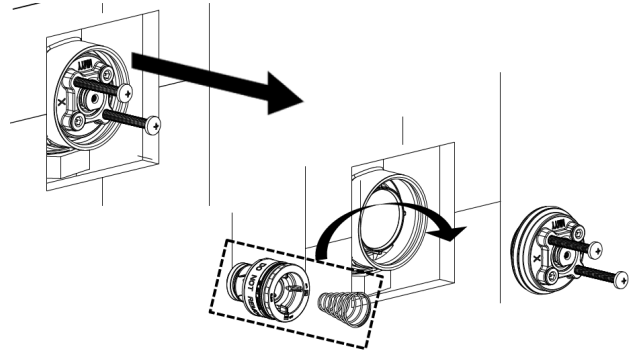

10. Insert the piston and conical spring then reinstall the activation assembly and safety ring.

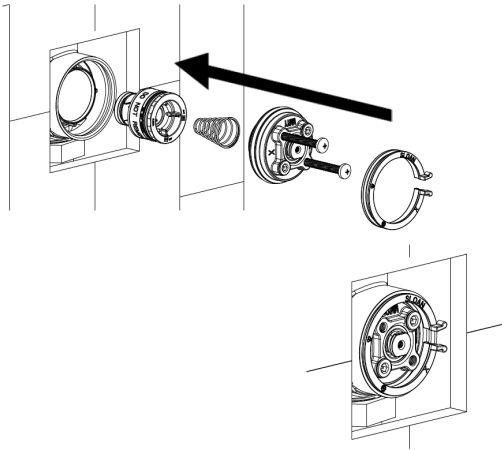

11. Use the activation tool to turn the activation assembly counterclockwise slowly to open the flow of water.
12. Push the plunger to activate flush and adjust the flow as needed by rotating the activation assembly (clockwise to reduce flow and counterclockwise to increase the flow).

NOTE: Make sure there are no leakages after assembly.

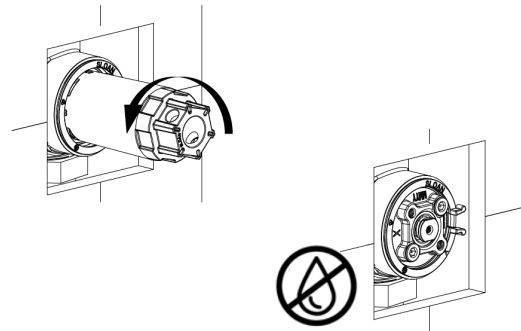

!!! IMPORTANT !!!

THE ACTIVATION ASSEMBLY SHOULD NEVER BE OPENED TO THE POINT WHERE THE FLOW FROM THE VALVE EXCEEDS THE FLOW CAPABILITY OF THE FIXTURE. IN THE EVENT OF A VALVE FAILURE, THE FIXTURE MUST BE ABLE TO ACCOMMODATE A CONTINUOUS FLOW FROM THE VALVE.

!!! IMPORTANT !!!

THE FLUSHOMETER IS ENGINEERED FOR QUIET OPERATION. EXCESSIVE WATER FLOW CREATES NOISE, WHILE TOO LITTLE WATER FLOW MAY NOT SATISFY THE NEEDS OF THE FIXTURE. PROPER ADJUSTMENT IS MADE WHEN PLUMBING FIXTURE IS CLEANSSED AFTER EACH FLUSH WITHOUT SPLASHING WATER OUT FROM THE LIP AND A QUIET FLUSHING CYCLE IS ACHIEVED.

3. INSTALL BUTTON / BRACKET ASSEMBLY

Refer to the Wall Plate Installation Manual (08160049).

Wall Plate Assembly Installation Manual (08160049)
available on www.sloan.in.

For complete listing of items available for repair, please consult
the Maintenance and Repair Guide.

The information contained in this document is subject to change without notice.

SLOAN INDIA PRIVATE LIMITED • 344, PHASE-II UDYOG VIHAR, GURUGRAM 12015 INDIA

Phone: +91 124 490 8588 • Toll Free: 1800.123.3080 • customercare@sloan.in • www.sloan.in